

Copying of this document, and giving it to others and use or communication of the contents thereof, are forbidden without express authority. Offenders are liable to the payment of damages. All rights are reserved in the event of the grant of a patent or the registration of a utility model or design.

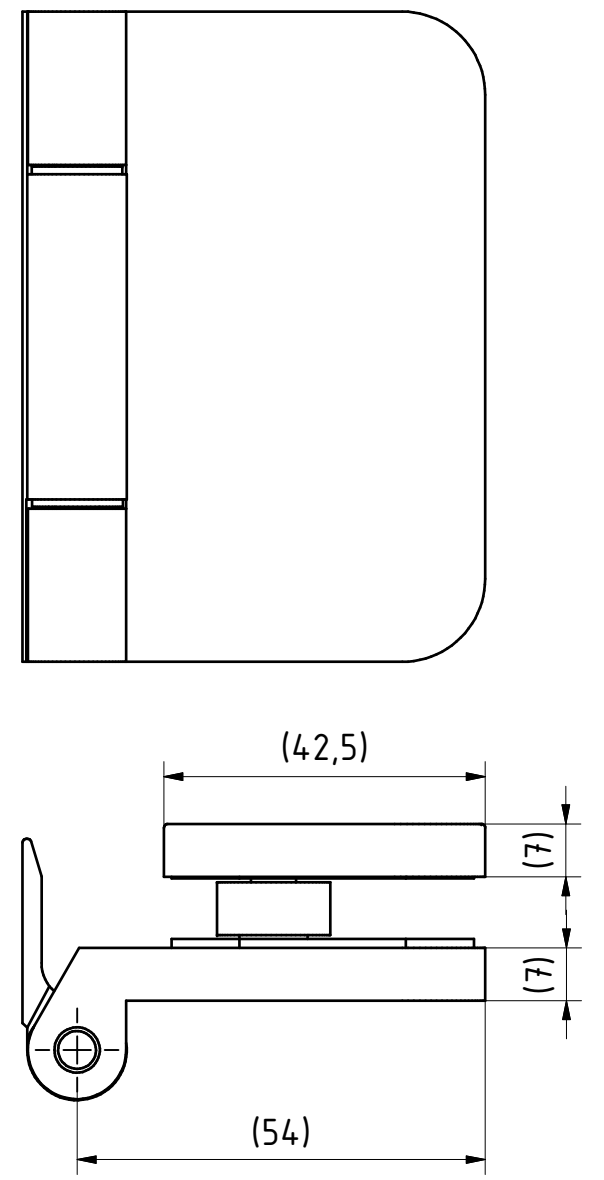
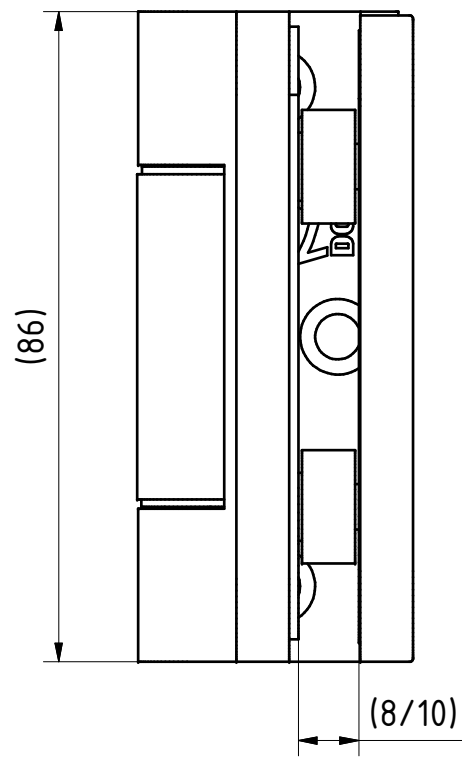
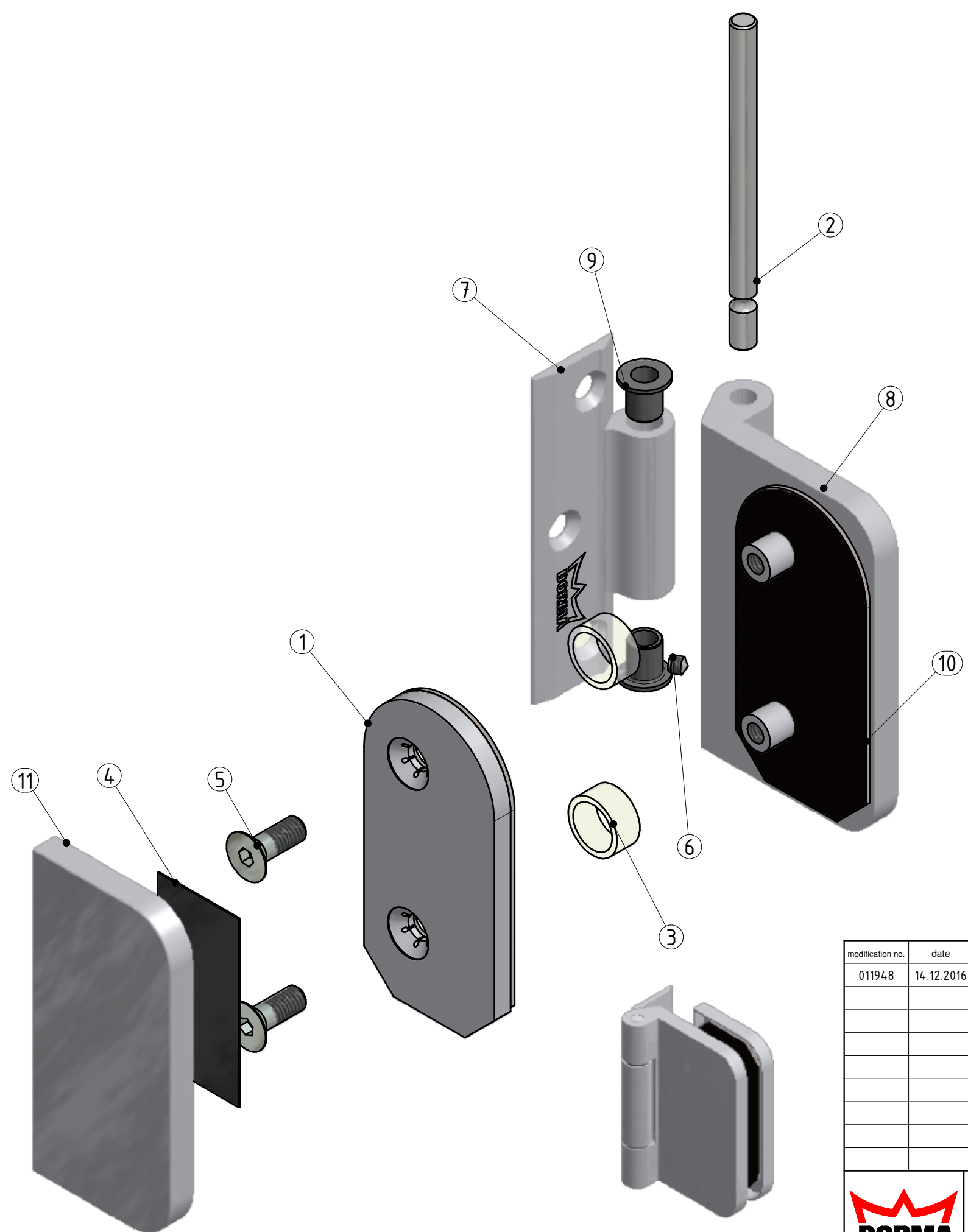

No.	Units	Part number	Description
1	1	81100200250	Counter-plate, compl.
2	1	81208700140	Pin
3	2	80100500240	Tube section $\varnothing 12/\varnothing 15-7$
4	1	80018082432	Double-sided tape, 25x50x0,4
5	2	80001045330	DIN 7991 - M6 x 16 - 8.8 verz.
6	1	80001168330	ISO 7434 - M4x4 - A1
7	1	81208500140	Frame part
8	1	81209100140	Door leaf part
9	2	80011016332	Igius-GFM0608-10
10	1	81100300240	Gasket
11	1	81100500140	Cap, round

modification no.	date	name	tolerances for linear measures without individual tolerance registration according to ISO 2768 part 1							fit			
011948	14.12.2016	herthho	degree of exactness	from 0,5 to 6	over 6 to 30	over 30 to 120	over 120 to 400	over 400 to 1000	over 1000 to 2000	over 2000 to 4000	maximum size	minimum size	
			middle	$\pm 0,1$	$\pm 0,2$	$\pm 0,3$	$\pm 0,4$	$\pm 0,5$	$\pm 1,2$	± 2			
			tolerances for angular measures without individual tolerance registration according to ISO 2768 part 1										
			degree of exactness	up to 10mm	over 10 to 30	over 30 to 120	over 120 to 400	over 400					
			middle	$\pm 1^\circ$	$\pm 0^\circ 20'$	$\pm 0^\circ 20'$	$\pm 0^\circ 10'$	$\pm 0^\circ 5'$					
			shape and positional tolerances without individual tolerance registration according to ISO 2768 part 2, tolerance class K										
			constructor	H.Herth	08.11.2016	material				weight	0,211 kg	CADsys Inventor	
			drawn	H.Herth	08.11.2016					project no.		format A3	
			checked							product state	Serie		
			released							made of:			

scale

1:1

for doors independent from frame 55kg (8/10mm glass)

CLARIT hinge round, compl.

part no.

81209100155

\$\\Daten\\Serienteile-Freigabe\\8-12\\81209100155.idw